

PRODUCT DESCRIPTION

Add color to virtually any fluorescent light source, fast and affordable.

- Flat welded tube of Rosco color filter. QuickColor Sleeves puff open like an envelope to easily slide over a fluorescent tube.
- Use QuickColor Sleeves on fluorescent lamps to add color, balance color temperature or block harmful UV rays.
- Choose from any Rosco color filter; Roscolux, Supergel, Cinegel, E-Colour
- Available in sizes for T12, T8 and T5 fluorescent lamps.
- Nominal 22.5", 48" or 60" length, easily cut with scissors or razor knife
- Can be made for compact fluorescent lamps upon request
- Custom sizes and shapes available, contact Rosco for details
- No minimum quantities required.
- Folded flat for easy shipping and storage.
- RoHS compliant. Meets international Flame-retardant standards. Documentation available on request.
- One-year color fast warranty on standard fluorescent lamps (excludes HO or VHO lamps*)

PRODUCT NUMBERS

QuickColor Sleeve: 110-08430-AA-BB-COLOR

AA = Length. Use "48" for 4' Fluorescent lamps.
Use "XX" for custom length.

BB = Diameter.
Use "12" for T12, "08" for T8, "05" for T5

COLOR= Specify Rosco color number
(eg. "02" for Roscolux 02)

Example: 4' T8 with Roscolux 02 = 110-08430-4808-02

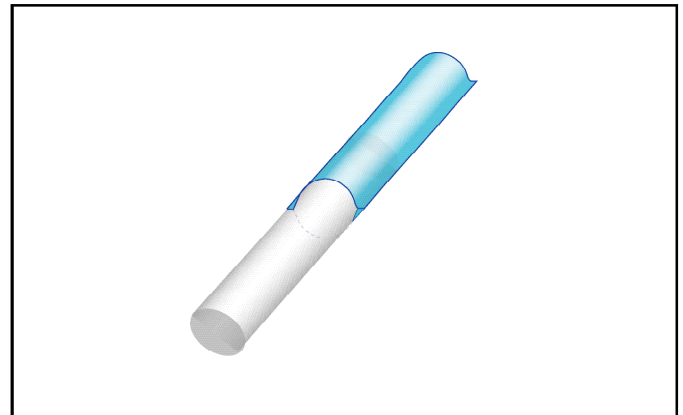

USAGE NOTES

*Rosco does not advise the use of QuickColor or Fluorescent Sleeves on High Output (HO) or Very High Output (VHO) lamps due to excessive heat generated at the electrodes. In some instances this can cause plastic color filters or tube guards to prematurely fail, or even melt.

The use of Rosco UV filter in QuickColor Sleeves or Fluorescent Sleeves may increase the durability of these products in typical installations. UV Filter will NOT prevent premature degradation on HO or VHO lamps.

Rosco Color Filters are made to exacting standards using the highest grade polymers and dyes stuffs available. However, due to variations among fixtures, ballasts, lamp types and UV output, the longevity of QuickColor Sleeves or Fluorescent Sleeves cannot be precisely determined. Color fading may occur over time.